

6 Princes Crescent

BH2020/00776



Brighton & Hove
City Council

Application Description

- Demolition of existing house and erection of new detached two storey dwellinghouse (C3)

Existing Location Plan

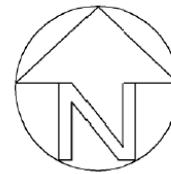
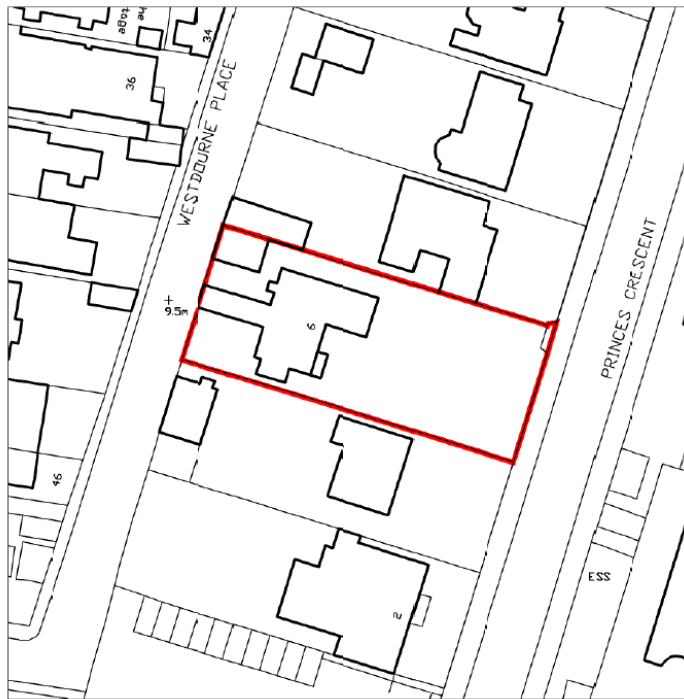

Site location plan Scale 1:1250 @A3



ID



Aerial photo(s) of site



Brighton & Hove
City Council

3D Aerial photo of site



Brighton & Hove
City Council

Street photo(s) of site



Front elevation, taken from Princes Crescent



Brighton & Hove
City Council

Other photo(s) of site



Front elevation, taken from Princes Crescent



Brighton & Hove
City Council

Other photo(s) of site



Front elevation, taken from Princes Crescent



Brighton & Hove
City Council

Other photo(s) of site



Rear elevation, taken from Westbourne Place, facing North



Brighton & Hove
City Council

Other photo(s) of site



Rear elevation, taken from Westbourne Place, facing South



Brighton & Hove
City Council

Map of application site



Existing & Proposed Block Plans



Existing block plan Scale 1:500 @A3

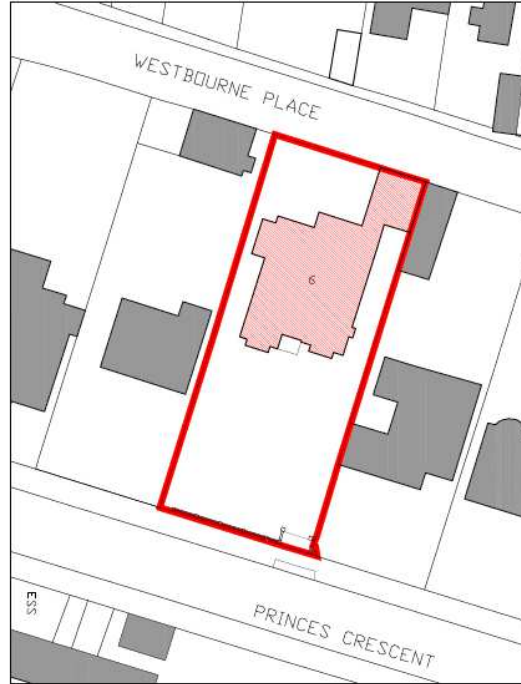

Proposed block plan Scale 1:500 @A3



12

ID



Proposed Front Elevation



Proposed front (east) elevation to Princes Crescent Scale 1:100 @A3

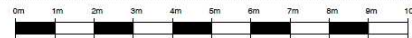

key

- A conservation type rooflight
- B patent glazing over gallery
- C plain tiled roof
- D facing brickwork to match existing
- E slimline metal windows with bronze colour finish
- F bronze colour metal spandrel panels

Proposed Rear Elevation



key

- A lead dormer
- B plain tiled roof
- C slimline metal windows with bronze colour finish
- D bronze colour metal spandrel panels

Existing Contextual Front Elevation



Existing street elevation to Princes Crescent Scale 1:200 @A3



15

TA 1259/11 A



Proposed Contextual Front Elevation



Proposed street elevation to Princes Crescent Scale 1:200 @A3

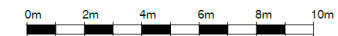

TA 1259/11 A



Existing Contextual Rear Elevation



Existing street elevation to Westbourne Place Scale 1:200 @A3

TA 1259/11 A

Proposed Contextual Rear Elevation



18

TA 1259/11 A



Brighton & Hove
City Council

Comparative Front Elevations

Extant Permission BH2019/03533

Current Proposal BH2020/00776



Comparative Rear Elevations

Extant Permission BH2019/03533

Current Proposal BH2020/00776



20

Comparative North Side Elevations

Extant Permission BH2019/03533



Current Proposal BH2020/00776



Comparative South Side Elevations

Extant Permission BH2019/03533



Current Proposal BH2020/00776



Key Considerations in the Application

- The design/appearance of the proposal
- The potential impact on the amenities of local residents
- Impact on nearby heritage assets
- Impact on the adopted highway



Brighton & Hove
City Council

Conclusion and Planning Balance

- The proposal would have a neutral impact on the significance of nearby heritage assets
- The impact(s) on the amenities of local residents has previously been found acceptable
- A building of this scale and general appearance benefits from an extant permission
- The proposal will create significant biodiversity and sustainability improvements



Brighton & Hove
City Council